

BD Series Hollow Cone Spray Nozzles

BD

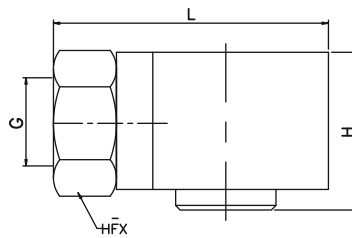

130° SPRAY ANGLE	CONNECTION END				ORIFICE SIZE (mm)	FLOW CAPACITY IN LPM AT DIFFERENT PRESSURE							G/A DIMENSION. MM			
	1"	1 1/2"	2"	2 1/2"		PRESSURE [BAR]							CONN.	H	L	HEX
MODEL NO.	BSP	BSP	BSP	BSP		0.5	1.0	2.0	3.0	5.0	7.0	10.0				
BD29.500	●				12.6	25.0	35.36	50.0	61.24	79.06	93.54	111.80	1"	60	94	46
BD29.630	●				14.1	31.5	44.55	63.0	77.16	99.61	117.86	140.87	Weight (Metals) = XX gms. Approx			
BD29.800	●				15.9	40.0	56.57	80.0	97.98	126.49	149.67	178.89	1 1/2"	75	112	60
BD39.100	●				17.8	50.0	70.71	100.0	122.47	158.11	187.08	223.61	Weight (Metals) = XX gms. Approx			
BD39.118		●			19.3	59.0	83.44	118.0	144.52	186.57	220.76	263.86	2"	90	140	75
BD39.130		●			20.3	65.0	91.92	130.0	159.22	205.55	243.21	290.69	Weight (Metals) = XX gms. Approx			
BD39.160		●			22.5	80.0	113.14	160.0	195.96	252.98	299.33	357.77	2 1/2"	127	193	90
BD39.200		●			25.1	100	141.42	200.0	244.95	316.23	374.17	447.21	Weight (Metals) = XX gms. Approx			
BD39.227		●			26.8	113.5	160.51	227.0	278.02	358.92	424.68	507.59				
BD39.337			●		32.6	168.5	238.29	337.0	412.74	532.84	630.47	753.55				
BD39.469			●		38.5	234.5	331.63	469.0	574.41	741.55	877.42	1048				
BD39.540				●	41.3	270	381.84	540.0	661.36	853.81	1010	1207				

End Connection : X – BSP, Y - BSPT, Z – NPT Available.