

BC Series Hollow Cone Spray Nozzles

BC

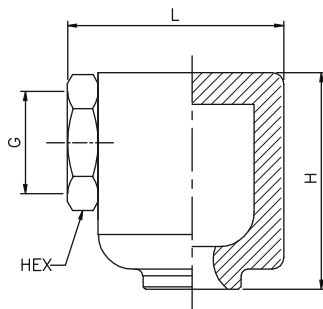

Fine uniform hollow cone spray also at low pressures.

Application:

Cooling and cleaning of gas, Water re-cooling, Dust control, Chemical process engineering .

75° SPRAY ANGLE	CONNECTION END				ORIFICE SIZE (mm)	FLOW CAPACITY IN LPM AT DIFFERENT PRESSURE							G/A DIMENSION. MM			
	1"	1 1/2"	2"	2 1/2"		PRESSURE [BAR]							CONN.	H	L	HEX
MODEL NO.	BSP	BSP	BSP	BSP		0.5	1.0	2.0	3.0	5.0	7.0	10.0	1"	60	75	46
BC25.500	●				10.5	25.0	35.36	50.00	61.24	79.06	93.54	111.80	Weight (Metals) = XX gms. Approx			
BC25.630	●				11.8	31.5	44.55	63.00	77.16	99.61	117.86	140.87	1 1/2"	90	92	60
BC25.800	●				13.3	40.0	56.57	80.00	97.98	126.49	149.67	178.89	Weight (Metals) = XX gms. Approx			
BC35.100	●				14.9	50.0	70.71	100.0	122.47	158.11	187.08	223.61	2"	127	118	80
BC35.118		●			16.2	59.0	83.44	118.0	144.52	186.57	220.76	263.86	Weight (Metals) = XX gms. Approx			
BC35.130		●			17.0	65.0	91.92	130.0	159.22	205.55	243.21	290.69	Weight (Metals) = XX gms. Approx			
BC35.160		●			18.8	80.0	113.14	160.0	195.96	252.98	299.33	357.77	2 1/2"	156	140	100
BC35.200		●			21.1	100	141.42	200.0	244.95	316.23	374.17	447.21	Weight (Metals) = XX gms. Approx			
BC35.227		●			22.4	113.5	160.51	227.0	278.02	358.92	424.68	507.59				
BC35.337			●		27.4	168.5	238.29	337.0	412.74	532.84	630.47	753.55				
BC35.469			●		32.3	234.5	331.63	469.0	574.41	741.55	877.42	1048.72				
BC35.540				●	34.6	270	381.84	540.0	661.36	853.81	1010.25	1207.48				

90° SPRAY ANGLE	CONNECTION END				ORIFICE SIZE (mm)	FLOW CAPACITY IN LPM AT DIFFERENT PRESSURE							G/A DIMENSION. MM			
	1"	1 1/2"	2"	2 1/2"		PRESSURE [BAR]							CONN.	H	L	HEX
MODEL NO.	BSP	BSP	BSP	BSP		0.5	1.0	2.0	3.0	5.0	7.0	10.0	1"	60	75	46
BC26.500	●				10.5	25.0	35.36	50.0	61.24	79.06	93.54	111.80	Weight (Metals) = XX gms. Approx			
BC26.630	●				11.8	31.5	44.55	63.0	77.16	99.61	117.86	140.87	1 1/2"	90	92	60
BC26.800	●				13.3	40.0	56.57	80.0	97.98	126.49	149.67	178.89	Weight (Metals) = XX gms. Approx			
BC36.100	●				14.9	50.0	70.71	100	122	158.11	187.08	223.61	2"	127	118	80
BC36.118		●			16.2	59.0	83.44	118	144	186.57	220.76	263.86	Weight (Metals) = XX gms. Approx			
BC36.130		●			17.0	65.0	91.92	130	159	205.55	243.21	290.69	Weight (Metals) = XX gms. Approx			
BC36.160		●			18.8	80.0	113	160	195	252.98	299.33	357.77	2 1/2"	156	140	100
BC36.200		●			21.1	100	141	200	244	316.23	374.17	447.21	Weight (Metals) = XX gms. Approx			
BC36.227		●			22.4	113.5	160.51	227	278.02	358.92	424.68	507.59				
BC36.337			●		27.4	168.5	238.29	337	412.74	532.84	630.47	753.55				
BC36.469			●		32.3	234.5	331.63	469	574.41	741.55	877.42	1048.72				
BC36.540				●	34.6	270	381.84	540	661.36	853.81	1010	1207				

End Connection : X – BSP, Y - BSPT, Z – NPT Available.