

ABC Angular Full Cone Spray Nozzles

DM

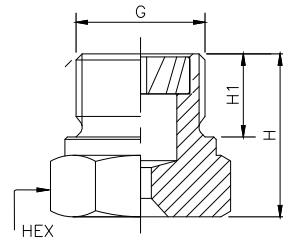

DM Series ABC Angular Full Cone Spray Nozzle form uniform spray pattern and spray coverage. It provides solid full cone pattern with uniform spray distribution of medium to large size drops resulting from their unique vane design.

Characteristic : Angular drill disc vane design

Type : Full cone spray pattern

45° SPRAY ANGLE	CONNECTION END			ORIFICE SIZE (mm)	FLOW CAPACITY IN LPM AT DIFFERENT PRESSURE							G/A DIMENSION. MM				
	1/2"	3/4"	1"		PRESSURE [BAR]							CONN.	H	H1	D	HEX
MODEL NO.	BSP	BSP	BSP		0.5	1.0	2.0	3.0	5.0	7.0	10.0					
DM13.400	●			2.3	2.00	2.83	4.00	4.90	6.32	7.48	8.94	1/2"	32	13	21	22
DM13.475	●			2.5	2.37	3.36	4.75	5.82	7.51	8.89	10.62	Weight (Metals) = 71 gms. Approx				
DM13.650	●			2.9	3.25	4.60	6.50	7.96	10.28	12.16	14.53	3/4"	42	15	32	27
DM13.800	●			3.3	4.00	5.66	8.00	9.80	12.65	14.97	17.89	Weight (Metals) = xx gms. Approx				
DM23.100	●			3.6	5.00	7.07	10.00	12.25	15.81	18.71	22.36	1"	56	18	39	36
DM23.125	●	●		4.1	6.25	8.84	12.50	15.31	19.76	23.39	27.95	Weight (Metals) = xx gms. Approx				
DM23.160	●	●		4.6	8.00	11.31	16.00	19.60	25.30	29.93	35.78					
DM23.180		●		5.9	9.00	12.73	18.00	22.05	28.46	33.67	40.25					
DM23.200		●	●	5.2	10.00	14.14	20.00	24.49	31.62	37.42	44.72					
DM23.225		●	●	5.5	11.25	15.91	22.50	27.56	35.58	42.09	50.31					
DM23.250		●	●	5.8	12.50	17.68	25.00	30.62	39.53	46.77	55.90					
DM23.320		●	●	6.5	16.00	22.63	32.00	39.19	50.60	59.87	71.55					
DM23.400			●	7.3	20.00	28.28	40.00	48.99	63.25	74.83	89.44					
DM23.520			●	8.3	26.00	36.77	52.00	63.69	82.22	97.28	116.28					
DM23.650			●	9.3	32.50	45.96	65.00	79.61	102.77	121.60	145.34					
DM23.720			●	9.8	36.00	50.91	72.00	88.18	113.8	134.7	161.0					

60° SPRAY ANGLE	CONNECTION END			ORIFICE SIZE (mm)	FLOW CAPACITY IN LPM AT DIFFERENT PRESSURE							G/A DIMENSION. MM				
	1/2"	3/4"	1"		PRESSURE [BAR]							CONN.	H	H1	D	HEX
MODEL NO.	BSP	BSP	BSP		0.5	1.0	2.0	3.0	5.0	7.0	10.0					
DM14.400	●			2.3	2.00	2.83	4.00	4.90	6.32	7.48	8.94	1/2"	32	13	21	22
DM14.475	●			2.5	2.37	3.36	4.75	5.82	7.51	8.89	10.62	Weight (Metals) = 71 gms. Approx				
DM14.650	●			2.9	3.25	4.60	6.50	7.96	10.28	12.16	14.53	3/4"	42	15	32	27
DM14.800	●			3.3	4.00	5.66	8.00	9.80	12.65	14.97	17.89	Weight (Metals) = xx gms. Approx				
DM24.100	●			3.6	5.00	7.07	10.00	12.25	15.81	18.71	22.36	1"	56	18	39	36
DM24.125	●	●		4.1	6.25	8.84	12.50	15.31	19.76	23.39	27.95	Weight (Metals) = xx gms. Approx				
DM24.160	●	●		4.6	8.00	11.31	16.00	19.60	25.30	29.93	35.78					
DM24.180		●		5.9	9.00	12.73	18.00	22.05	28.46	33.67	40.25					
DM24.200		●	●	5.2	10.00	14.14	20.00	24.49	31.62	37.42	44.72					
DM24.225		●	●	5.5	11.25	15.91	22.50	27.56	35.58	42.09	50.31					
DM24.250		●	●	5.8	12.50	17.68	25.00	30.62	39.53	46.77	55.90					
DM24.320		●	●	6.5	16.00	22.63	32.00	39.19	50.60	59.87	71.55					
DM24.400			●	7.3	20.00	28.28	40.00	48.99	63.25	74.83	89.44					
DM24.520			●	8.3	26.00	36.77	52.00	63.69	82.22	97.28	116.28					
DM24.650			●	9.3	32.50	45.96	65.00	79.61	102.77	121.60	145.34					
DM24.720			●	9.8	36.00	50.91	72.00	88.18	113.8	134.7	161.0					

ABC Angular Full Cone Spray Nozzles

90° SPRAY ANGLE	CONNECTION END			ORIFICE SIZE (mm)	FLOW CAPACITY IN LPM AT DIFFERENT PRESSURE							G/A DIMENSION. MM				
	1/2"	3/4"	1"		PRESSURE [BAR]											
MODEL NO.	BSP BSPT NPT	BSP BSPT NPT	BSP BSPT NPT		0.5	1.0	2.0	3.0	5.0	7.0	10.0	CONN.	H	H1	D	HEX
DM16.400	●			2.3	2.00	2.83	4.00	4.90	6.32	7.48	8.94	1/2"	32	13	21	22
DM16.475	●			2.5	2.37	3.36	4.75	5.82	7.51	8.89	10.62	Weight (Metals) = 71 gms. Approx				
DM16.650	●			2.9	3.25	4.60	6.50	7.96	10.28	12.16	14.53	3/4"	42	15	32	27
DM16.800	●			3.3	4.00	5.66	8.00	9.80	12.65	14.97	17.89	Weight (Metals) = xx gms. Approx				
DM26.100	●			3.6	5.00	7.07	10.00	12.25	15.81	18.71	22.36	1"	56	18	39	36
DM26.125	●	●		4.1	6.25	8.84	12.50	15.31	19.76	23.39	27.95	Weight (Metals) = xx gms. Approx				
DM26.160	●	●		4.6	8.00	11.31	16.00	19.60	25.30	29.93	35.78					
DM26.180		●		5.9	9.00	12.73	18.00	22.05	28.46	33.67	40.25					
DM26.200		●	●	5.2	10.00	14.14	20.00	24.49	31.62	37.42	44.72					
DM26.225		●	●	5.5	11.25	15.91	22.50	27.56	35.58	42.09	50.31					
DM26.250		●	●	5.8	12.50	17.68	25.00	30.62	39.53	46.77	55.90					
DM26.320		●	●	6.5	16.00	22.63	32.00	39.19	50.60	59.87	71.55					
DM26.400		●	●	7.3	20.00	28.28	40.00	48.99	63.25	74.83	89.44					
DM26.520		●	●	8.3	26.00	36.77	52.00	63.69	82.22	97.28	116.28					
DM26.650			●	9.3	32.50	45.96	65.00	79.61	102.77	121.60	145.34					
DM26.720			●	9.8	36.00	50.91	72.00	88.18	113.8	134.7	161.0					

130° SPRAY ANGLE	CONNECTION END			ORIFICE SIZE (mm)	FLOW CAPACITY IN LPM AT DIFFERENT PRESSURE							G/A DIMENSION. MM				
	1/2"	3/4"	1"		PRESSURE [BAR]											
MODEL NO.	BSP BSPT NPT	BSP BSPT NPT	BSP BSPT NPT		0.5	1.0	2.0	3.0	5.0	7.0	10.0	CONN.	H	H1	D	HEX
DM19.400	●			2.3	2.00	2.83	4.00	4.90	6.32	7.48	8.94	1/2"	32	13	21	22
DM19.475	●			2.5	2.37	3.36	4.75	5.82	7.51	8.89	10.62	Weight (Metals) = 71 gms. Approx				
DM19.650	●			2.9	3.25	4.60	6.50	7.96	10.28	12.16	14.53	3/4"	42	15	32	27
DM19.800	●			3.3	4.00	5.66	8.00	9.80	12.65	14.97	17.89	Weight (Metals) = xx gms. Approx				
DM29.100	●			3.6	5.00	7.07	10.00	12.25	15.81	18.71	22.36	1"	56	18	39	36
DM29.125	●	●		4.1	6.25	8.84	12.50	15.31	19.76	23.39	27.95	Weight (Metals) = xx gms. Approx				
DM29.160	●	●		4.6	8.00	11.31	16.00	19.60	25.30	29.93	35.78					
DM29.180		●	●	5.9	9.00	12.73	18.00	22.05	28.46	33.67	40.25					
DM29.200		●	●	5.2	10.00	14.14	20.00	24.49	31.62	37.42	44.72					
DM29.225		●	●	5.5	11.25	15.91	22.50	27.56	35.58	42.09	50.31					
DM29.250		●	●	5.8	12.50	17.68	25.00	30.62	39.53	46.77	55.90					
DM29.320		●	●	6.5	16.00	22.63	32.00	39.19	50.60	59.87	71.55					
DM29.400		●	●	7.3	20.00	28.28	40.00	48.99	63.25	74.83	89.44					
DM29.520		●	●	8.3	26.00	36.77	52.00	63.69	82.22	97.28	116.28					
DM29.650			●	9.3	32.50	45.96	65.00	79.61	102.77	121.60	145.34					
DM29.720			●	9.8	36.00	50.91	72.00	88.18	113.8	134.7	161.0					